

K 100 (W) GAS

Chlorine, Chlorine Dioxide and ozone gas measuring instrument

- Connection of one or two gas sensors
- Easy and safe operation by plain text menu guidance
- Safety by password function



applications



Lager-Abluftüberwachung



Ambient Air Monitoring



TLV Monitoring



Environmental Monitoring

description

The K 100 (W) GAS is a sophisticated instrument for continuous monitoring of gases in ambient air. The connection of one or two electrochemical sensors of the GE-700 series is possible.

particular characteristics

- Measuring ranges in the ppm-range depending on the used gas sensor
- Automatic sensor test, adjustable test cycle
- 3 potential-free contacts for limit value 1, limit value 2 and general alarm
- Zero current safe - the effective direction of the alarm relay is invertible
- Background illuminated two-line LC-Display
- Display of relay and error messages
- Scaleable, galvanically isolated 0/4 ..20 mA output



K 100 (W) GAS

Chlorine, Chlorine Dioxide and ozone gas measuring instrument

technical data

measuring parameter

Chlorine Gas	0.00 .. 10.00 ppm
Ozone Gas	0.00 .. 1.00 ppm
Chlorine Dioxide Gas	0.00 .. 1.00 ppm

input characteristics

accuracy	Depending on the sensor
----------	-------------------------

output characteristics

output signal	0/4 .. 20 mA (measured value sensor 1 or sensor 2)
load	max. 500 Ohm
registration range	Free adjustable within the measuring range
serial interface	RS 485 (optional)
Baud rate	9600
data format	8 bit

power supply

line voltage	24/ 117/ 230 VAC, +6/-10%, 40 .. 60 Hz
power consumption	10 VA

ambient conditions

ambient temperature	operation 0 .. +50 °C , storage -20 .. +65 °C
relative humidity	max. 90% rH at 40°C (non-condensing)
protection class	panel mounted housing IP 54 (front), IP 30 (housing)
	wall mounted housing IP 65

controller

digital input	Stop via external contact
---------------	---------------------------

certificates and approvals

CE-symbol	Declaration of conformity: The product meets the requirements of the harmonized European standards. It thus complies with the legal requirements of the EC directives. The manufacturer confirms successful testing of the product by affixing the CE symbol.
-----------	--

mechanical construction - panel mounted housing

material	Noryl
dimensions	90x90x116
installation dimensions	92x92x140
weight	0.75 kg
connection	Push-screw terminals



K 100 (W) GAS

Chlorine, Chlorine Dioxide and ozone gas measuring instrument

mechanical construction - wall mounted housing

material	ABS
dimensions	165x160x85
weight	0.95 kg
connection	Spring-loaded terminals

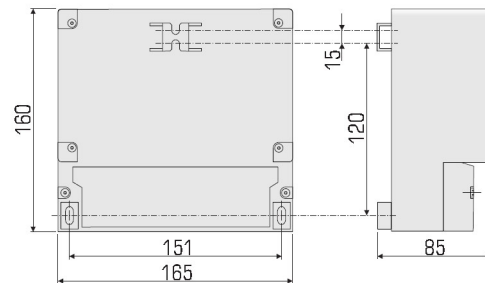
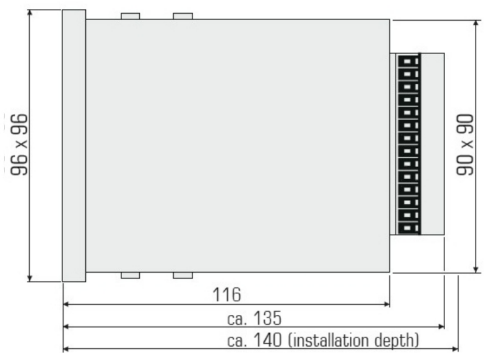

accessories

assemblies

GSH	Gas sensor holder for one sensor of the GE 700 series including 10 m cable.
-----	---

sensors

GE 710 CL2	Sensor for measuring Chlorine gas
GE 715 CLO2	Sensor for measuring Chlorine Dioxide gas
GE 760 O3	Sensor for measuring Ozone gas

